



# James N. Allan

## Interim Management Statement

**JAMES N. ALLAN  
PROVINCIAL PARK**

**INTERIM MANAGEMENT  
STATEMENT**

March, 1985

This Interim Management Statement will provide interim direction for the management of James N. Allan Candidate Provincial Park until a comprehensive Park Management Plan is prepared.

This statement will provide the basis for the subsequent preparation of the Park Management Plan.

I am pleased to approve this Interim Management Statement for James N. Allan Candidate Provincial Park.

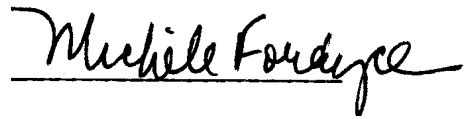
A handwritten signature in black ink that reads "Michelle Fordyce". The signature is written in a cursive style and is underlined.

M. Fordyce  
Regional Director  
Central Region

## BACKGROUND INFORMATION

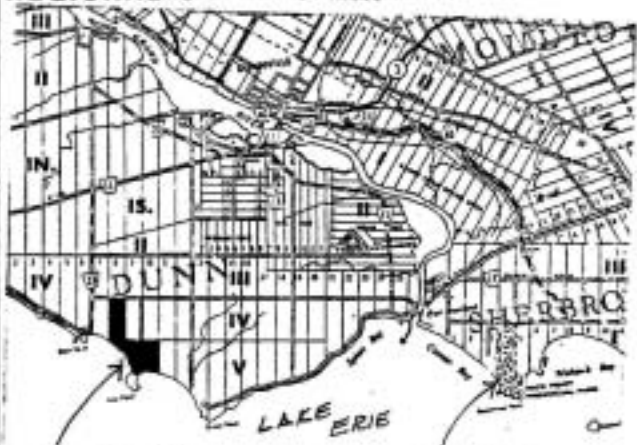
<b>NAME:</b> James N. Allan Candidate Provincial Park	<b>REGIONAL SETTING MAP</b>  <p style="font-size: small;">James N. Allan Candidate Provincial Park Figure 1</p> <p style="font-size: small;">Rock Point Provincial Park</p>
<b>PROPOSED CLASS:</b> Recreation	
<b>M.N.R. DISTRICT:</b> Niagara	
<b>M.N.R. REGION:</b> Central	
<b>TOTAL AREA(ha):</b> 113 ha <b>LAND:</b> <b>WATER:</b>	
<b>SITE REGION:</b> 7	
<b>SITE DISTRICT:</b> 7-2	
<b>DATE in REGULATION:</b> 1986	

## TARGETS

### 1 LIFE SCIENCE REPRESENTATION

site type/landscape unit	species/communities
Southern Deciduous Forest Region (Hills)	-Beach - grasses, horsetail, wild grape, hedge-
Niagara Section of the Deciduous Forest	bindweed
Region (Rowe)	-Marsh - arrowhead, cattail, grasses
Haldimand Clay Plain (flat terrain with	-Cleared Field
extensive areas of swampy lowland)	-Deciduous Swamp Forest - red ash, American elm,
Lake Erie Coast Environmental Subregion	hop hornbeam, ironwood
	-Deciduous Upland Forest - red oak, white and
	red ash, shagbark, hickory, basswood
	-Old Field - bluegrass, timothy, hawthorn, red
	ash, American elm

### 2 EARTH SCIENCE REPRESENTATION

geological theme	feature
Middle Devonian	-Edgecliff member (limestone)
Port Huron Stadial	-sands and silts of glacial Lake Warren (Halton
Holocene	Till)
	-tombolo (sand bar connecting an island to
	mainland)

### 3 CULTURAL RESOURCE REPRESENTATION

theme	theme segment
Ø	Ø

#### 4 RECREATION OPPORTUNITIES

day use	car camping	wilderness/back country
Niagara D.L.U.G. picnic tables - 330 metres beach - 1,100	---	---

#### INVENTORIES

level	type	earth science	life science	cultural	recreational	other
reconnaissance		1977 Woerns Earth Science Inventory Checklist	1980, Macdonald Life Science Inventory Checklist		1984 J. Belan and S. Moreau Niagara District Land Use Guide- lines	
detailed			1984, Gould A Reconnaissance Biological Inventory of James N. Allan Park Reserve			
required						

## MANAGEMENT GUIDELINES

### I Land Tenure

Approximately 24 hectares in Lots 9 and 10 of Concession V, are rented out for agricultural purposes (corn and soybeans). This use of parklands will be periodically reviewed.

The main road allowance between Lots 9 and 10, Concession IV and V is owned and maintained by the Ministry. The cottagers along the lakeshore have right-of-way over this road.

### II Land Acquisition/Disposal

One cottage lot (one-quarter hectare) surrounded by parkland remains to be purchased along the western coast of the park (Lot 8, Concession V). At the time of writing this plan, negotiations are underway to secure this lot.

Although not a high priority, if funds become available and priorities permit, two additional areas are worth considering for acquisition, namely: (1) the peninsula of land jutting into the lake (Low Point) and (2) waterfront cottages fronting along the eastern side of the park.

### III Existing/Proposed Development

A gravel road, approximately 1.6 km long, with ditching along approximately 75% of its length, provides access into the park for park users and access to the cottages. An eastern branch of this road, still on Ministry property, provides access to the cottages on the park's eastern side. A small parking lot is located adjacent to the beach.

A concrete pad, the remnant of a past building, is located on the park's west side.

The Ministry maintains all of the fences along the park's boundary.

Recommendations:

Ditching on both sides of the main road, along its entire length should be completed.

The parking lot at the beach is too small and because of its location, is continually being sanded in. This increases the maintenance of the lot substantially. Consideration should be given to relocating the lot to the north side of the road.

The draining ditch outlet into Lake Erie will be monitored and cleaned out as required.

Security and garbage pickup will be performed on a regular basis from Rock Point Provincial Park.

FIGURE 2

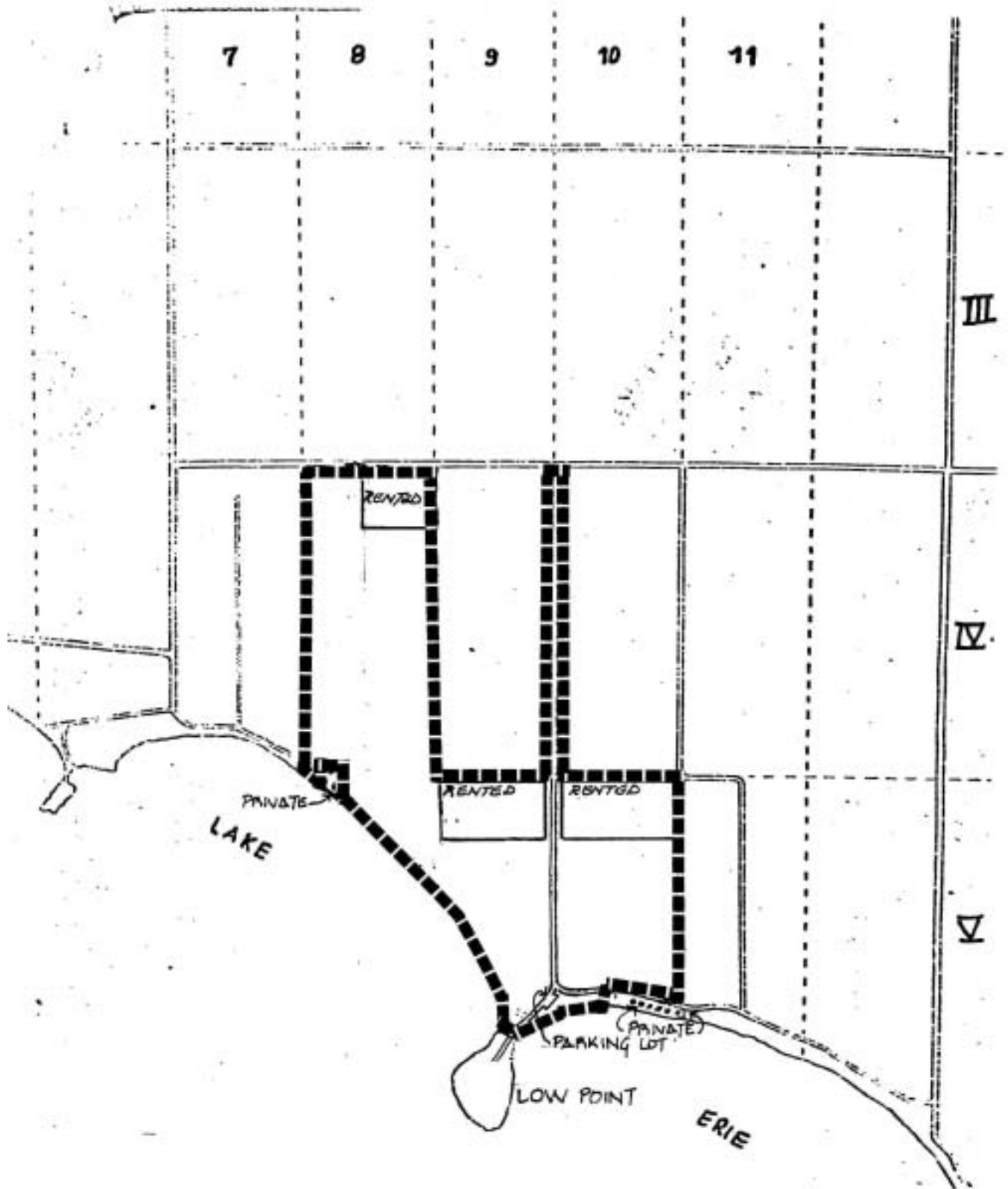

JAMES N. ALLAN  
CANDIDATE PROVINCIAL  
PARK 1" = 1320'

■■■■ PARK BOUNDARY

At some point in the future, if deemed necessary, signs may be posted indicating land ownership and park status.

#### IV Recreation Activities

Common recreation activities that occur here include: swimming, sunbathing, walking, boating and bird watching. With the exception of hunting, existing recreation activities will be allowed to continue. Hunting will not be permitted after 1986.

To control use, the site has been posted as day use only, open from 6 a.m. - 9 p.m. The local Ontario Provincial Police will be made aware of the existence and status.

The Niagara District Land Use Guidelines recommend the following:

Picnicking ..... 79,300 opportunities ..... 330 tables  
Swimming ..... 208,500 opportunities ..... 1,100 metres of beach

Actual number of facilities and opportunities to be provided will be determined in the future by the James N. Allan Provincial Park Management Plan.

#### V Natural Resources

High water levels and the natural dynamics of Lake Erie have contributed to loss of beach, bluff and vegetation through erosion. Any new development will be kept well back from the shoreline.

Extensive reforestation has occurred. Since the survival rate is low, replanting will occur as funds become available. Funding must also be available for minimum maintenance of new plantings, especially during the first few years.

A 2-ha parcel is currently planted as a hybrid poplar research plot, managed by district Forestry staff.

Agricultural use can continue on parkland until such time as lands are needed for other purposes.

The existing woodlots are at an age and state where they require very little management in the near future.

Commercial trapping will be not permitted. Trapping as a management technique may occur where it is necessary to deal with nuisance animals.

#### VI Marketing

Even though this park will be regulated as a provincial park in 1986, there are no plans in the near future to promote its use, apart from general information provided to the public regarding Public Land holdings.



## BIBLIOGRAPHY

- Gould, J., 1984. A Reconnaissance Biological Inventory of James N. Allan Park Reserve.
- Ministry of Natural Resources, 1972. James N. Allan Park Reserve, Data for Master Planning.
- Ministry of Natural Resources, 1976. Interim Forest Management Plan for James N. Allan Park Reserve.
- Ministry of Natural Resources, 1977. An Evaluation of Earth Science Features in the Parks, Park Reserves and Special Areas of Central and Southwestern Regions.
- Ministry of Natural Resources, 1978. Ontario Provincial Parks Planning and Management Policies.
- Ministry of Natural Resources, 1979. First Draft Provincial Parks Systems Plan.
- Ministry of Natural Resources, Life Science Features of the Haldimand Clay Plain Physiographic Region.
- Ministry of Natural Resources, 1983. Niagara District Land Use Guidelines.
- Ministry of Natural Resources, (1983-84). James N. Allan Park Reserve Interim Management Guidelines.
- File: General File 6609-05-26 (Central Region)